

NABCO ENTRANCES TECHNICAL BULLETIN

S82 W18717 Gemini Drive
Muskego, WI, 53150
Phone: (877) 622-2694, Fax: (888) 679-3319
www.NabcoEntrances.com

Date: August 23, 2012

Who is the technical contact?
Mike Buckley

Improvements to Swinger Arms

Following an ongoing product improvement program, we have made changes to the design of the GT 400/500/600 and GT 710 outswing arms and external stops. This change is effective immediately.

Refer to illustrations 1 and 2 below. Illustration # 1 shows the previous arm and stop and illustration # 2 shows the current arm and stop design. As can be seen in illustration # 2, the new arm is a strengthened design.

NOTE:

The new arm cannot be used with previous style stops. The new stop P/N 14-11586 may be purchased separately since it will accommodate previous outswing arm designs.

The new arm is available as assembly P/N 22-13992 as shown below.

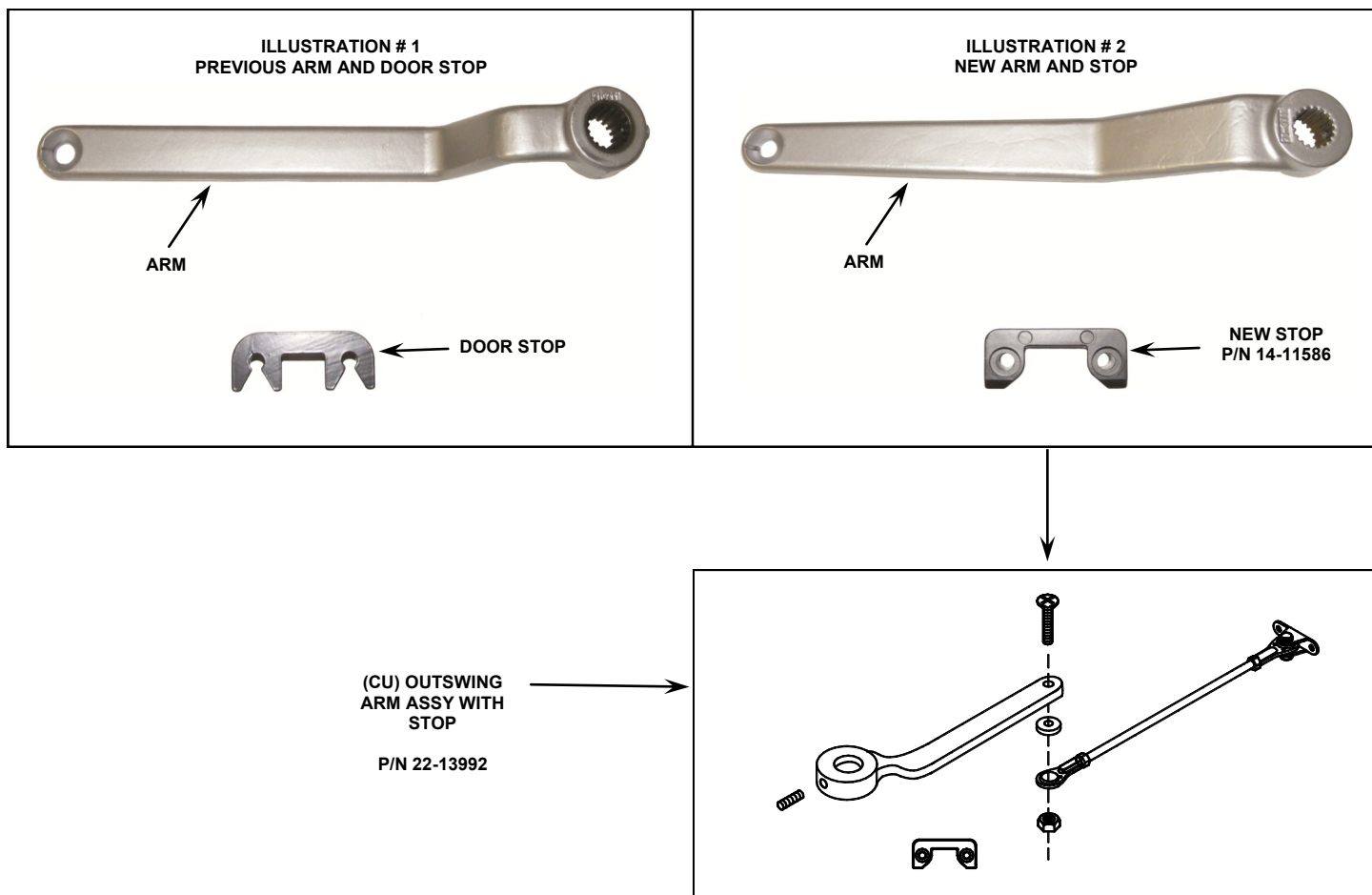

Bulletin Number: **56**