



## GT2150 Full Open w/Track Self Close Slide Door

### Quick Set-Up Parts Guide

P/N 15-12499-008 Rev 12-19-14

Nabco Entrances Inc. 582 W18717 Gemini Drive Muskego, Wisconsin 53150

Phone: (877) 622-2694 Fax: (888) 679-3319 [www.nabcoentrances.com](http://www.nabcoentrances.com)

Associated Manuals Part Numbers: *Architectural Specifications Manual*  
*"GT 2150 Manual Slider Installation Manual" (P/N 15-12941)*

#### **WARNING**

- Turn OFF all power to the Automatic Door if a Safety System is not working.
- Instruct the Owner to keep all power turned OFF until corrective action can be achieved by a NABCO trained technician. Failure to follow these practices may result in serious consequences.
- NEVER leave a Door operating without all Safety detection systems operational.

### *Table of Contents*

1	INSTALL FRAME .....	2
2	POSITION THE FLOOR TRACK .....	2
3	INSTALL THE SWING SIDELITE PANEL .....	2
4	ADJUST THE BALL DETENTS .....	4
5	INSTALL THE SLIDE DOOR .....	4
6	SECURE THE FLOOR TRACK .....	5
7	ADJUSTMENTS .....	5
8	SELF CLOSE HEADER .....	6
	SERVICE PARTS: HEADER .....	9
	SERVICE PARTS: CARRIER .....	11
	SERVICE PARTS: FULL OPEN SIDELITE .....	12
	SERVICE PARTS: RIGHT HAND FULL OPEN SIDELITE .....	13
	SERVICE PARTS: LEFT HAND FULL OPEN SIDELITE .....	14
	SERVICE PARTS: SLIDE DOOR .....	16
	SERVICE PARTS: RIGHT HAND SLIDE DOOR .....	17
	SERVICE PARTS: LEFT HAND SLIDE DOOR .....	18

## 1 Install Frame

1. Go to the non-breakout side of rough opening. Place Header on a flat surface with the removable cover facing up.
2. Refer to the instruction sticker located on each Jamb Tube to properly orientate Jamb Tubes.
3. Remove Cover from Header. Remove Parts boxes and/or Parts bags from inside Header. Set aside.
4. Secure Frame to Rough Opening with 1/4 inch diameter anchors or 3/8 inch threaded rods, with a maximum 48 inches on center for the Header and Jamb Tubes (First anchor maximum is 36 inches from each end of the Header).

## 2 Position the Floor Track

*Note: Do Not Secure Floor Track until both the Sidelite and Slide Door have been installed. Failure to do so may cause misalignment.*

1. Obtain Floor Track that was cut to specification at the NABCO Factory.
2. If not installed, obtain Filler Inserts and Threshold Bumpers that were provided by NABCO (cut to specifications).

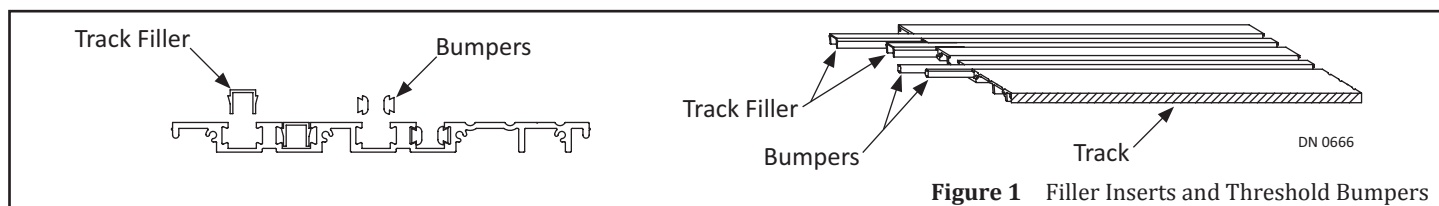

**Figure 1** Filler Inserts and Threshold Bumpers

3. Install Filler Inserts within areas that has a door opening. Please see Figure 2.
4. Install Threshold Bumpers within areas that does not have a door opening.

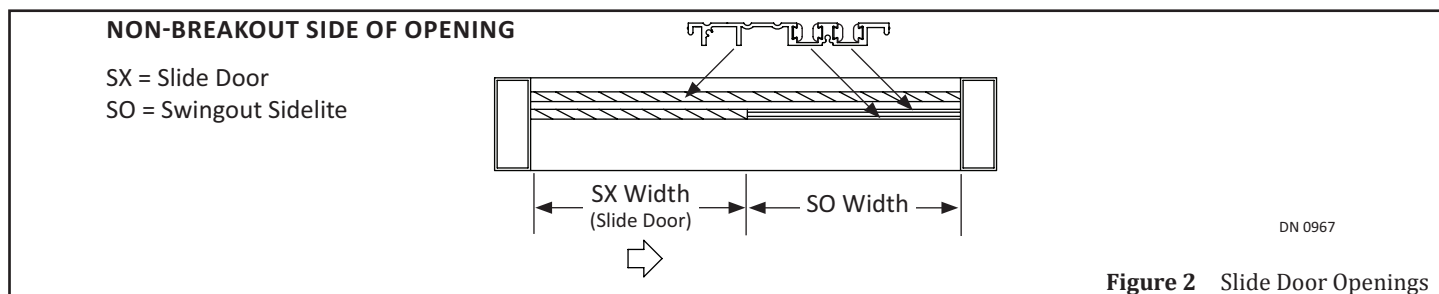
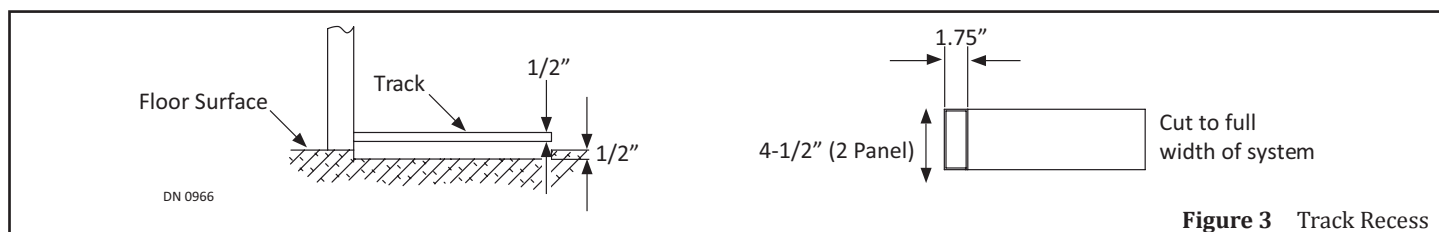

**Figure 2** Slide Door Openings

5. On the **Non-Breakout side of opening**, snap a chalk line on the floor from Jamb to Jamb.
6. Position the Floor Track between Jamb tubes until the full length is flush with the chalk line.
  - a. The Floor Track (not including the Ramps) is the same width as the Jamb Tube for both types of Units.

### 2.1 Recessed Floor Track (Only)

1. Remove the Floor Track. Set aside.
2. Create a channel that is 1/2 inch deep x full width of Jamb Tube x full length of the Floor Track.
  - a. Full length of Floor Track and width of Jamb Tube will vary according to specifications.



**Figure 3** Track Recess

## 3 Install the Swing Sidelite Panel

1. Obtain the Bottom Pivot assembly provided by NABCO.
2. Insert the Bottom Pivot into a Notch located at the bottom of Jamb tube.
3. Secure Bottom Pivot to Jamb tube with (1) 1/4-20 x 3/4 inch Self Tapping screw.
4. Secure the Bottom Pivot to the Floor with (1) 1/4-20 x 1/2 inch Phillips Screw.
5. Cap the barrel of Pivot with a Bushing provided by NABCO.

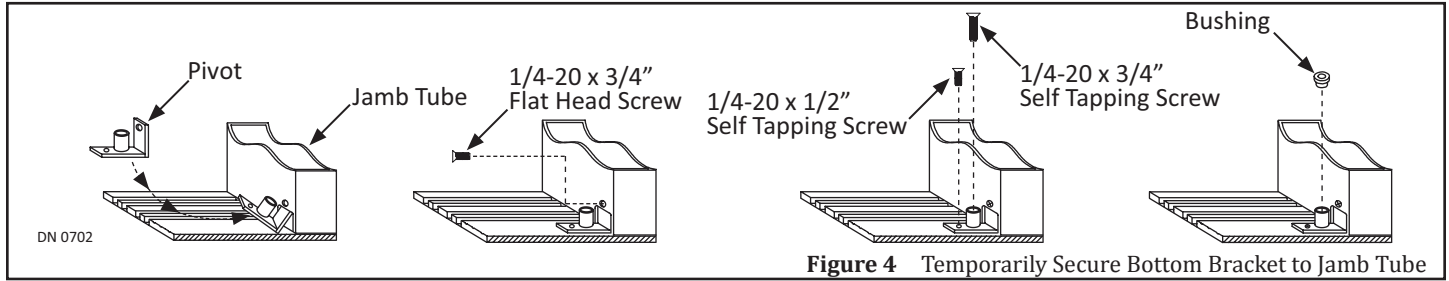

**Figure 4** Temporarily Secure Bottom Bracket to Jamb Tube

6. Obtain (1) Limit Arm Assembly provided by NABCO.
7. Slide (1) Spacer onto the Red Coated 1/4-20 x 1 Flat Head screw. Insert the Red Coated 1/4-20 x 1 Flat Head screw through the Limit Arm screw hole.
8. Slide (1) small Washer and (1 - 2) large Washers (as required) on top of the Red Coated Screw.
9. Secure the Limit Arm to the bottom lip of Header Cover by inserting the Screw assembly into the Factory Drilled Hole.
10. Tighten the Red Coated Screw so the Limit Arm Assembly does not fall out of hole. Do not fully tighten screw at this time.

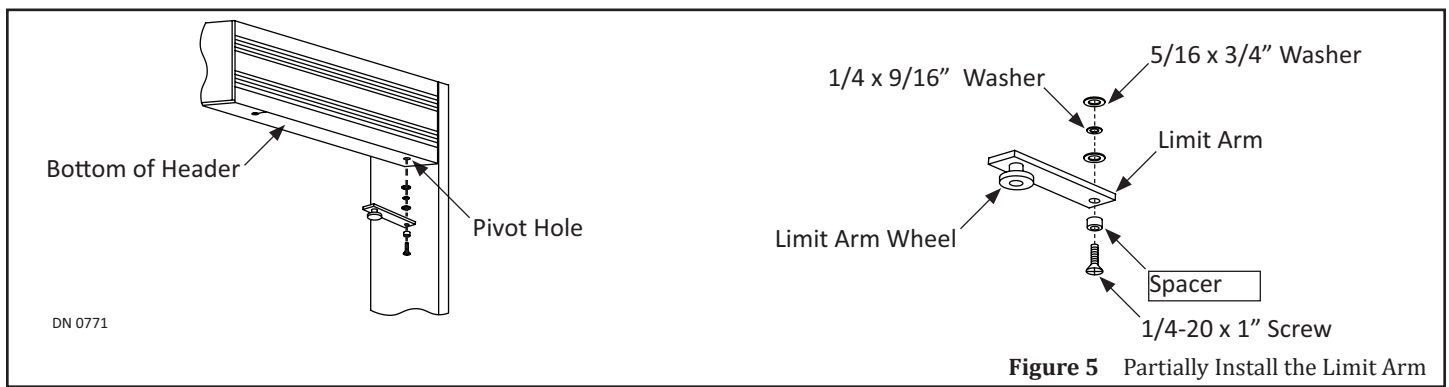

**Figure 5** Partially Install the Limit Arm

11. Carefully position the Swing Sidelite Panel over the Bottom Pivot. Ensure the Breakout side of the Swing Sidelite Panel is on the breakout side of the opening.

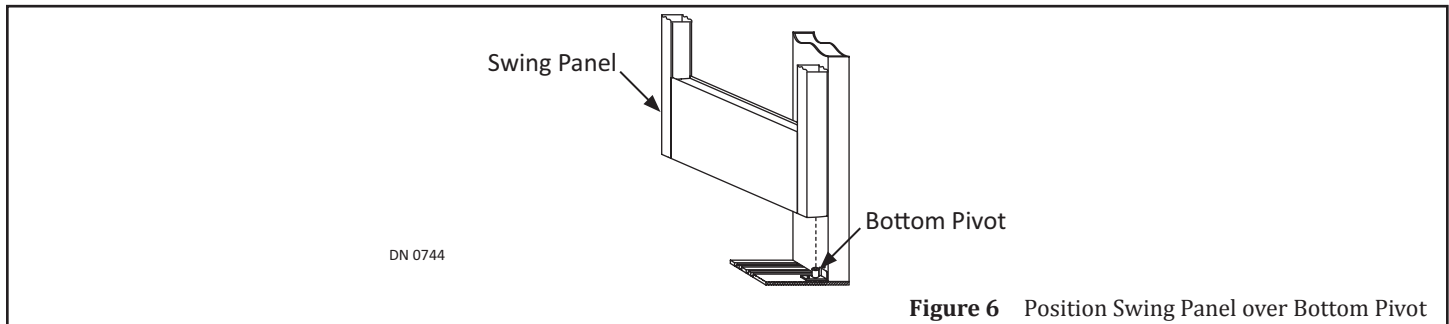

**Figure 6** Position Swing Panel over Bottom Pivot

12. Go to the Retracting Pin located inside the Pivot Stile at the very top.
13. Push the Retracting Pin down. At the same time, align the Pivot Pin with the Top Pivot Bracket hole located on bottom of Header. Allow the Pivot Pin to snap into the hole located on the Top Pivot Bracket.
  - a. Ensure Pivot Pin fully engages the hole. If necessary, lift up on the retracting pin with a screwdriver.

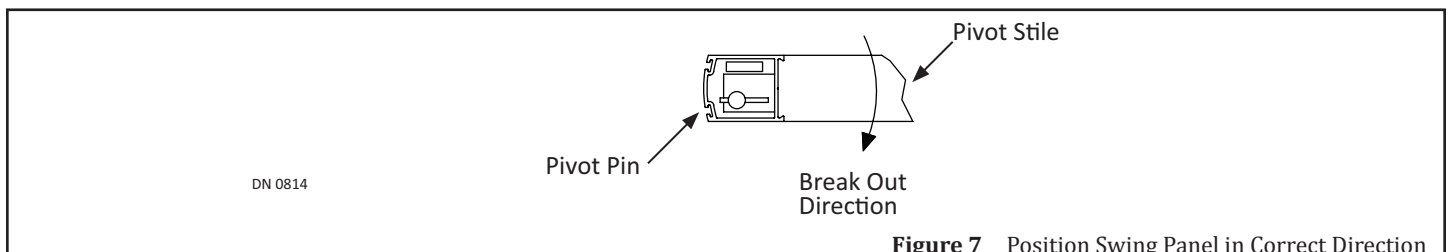

**Figure 7** Position Swing Panel in Correct Direction

14. Open the Swing Sidelite Panel out to 90 degrees. Align the Limit Arm with the Top Rail.
15. Rest the Wheel of the Limit Arm inside the Top Rail.

16. Open the Swing Sidelite Panel all the way.
17. Tighten the Red Coated 1/4-20 x 1 Flat Head screw. Do not overtighten.
18. Test the Swing Sidelite Panel to ensure it opens and closes properly. Tighten and/or untighten Red Coated 1/4-20 x 1 Flat Head screw as deemed necessary.

#### 4 Adjust the Ball Detents

*Note: Breakout resistance for Ball Detents must meet ANSI Standard A156.10 or Local Codes.*

1. With a 15/16" Open End wrench, loosen the Nut to raise or lower the Ball Detent at Top of Strike Stile so it has light contact with the Bottom of Header.
2. Open and close the Swing Door several times to score the surface on the Bottom of Header. Locate and mark where the Score intersects the center groove.
3. With a 1/4 inch diameter drill bit, drill a screw hole through the Bottom of Header. Countersink the screw hole to be 3/8 inch x 82°.

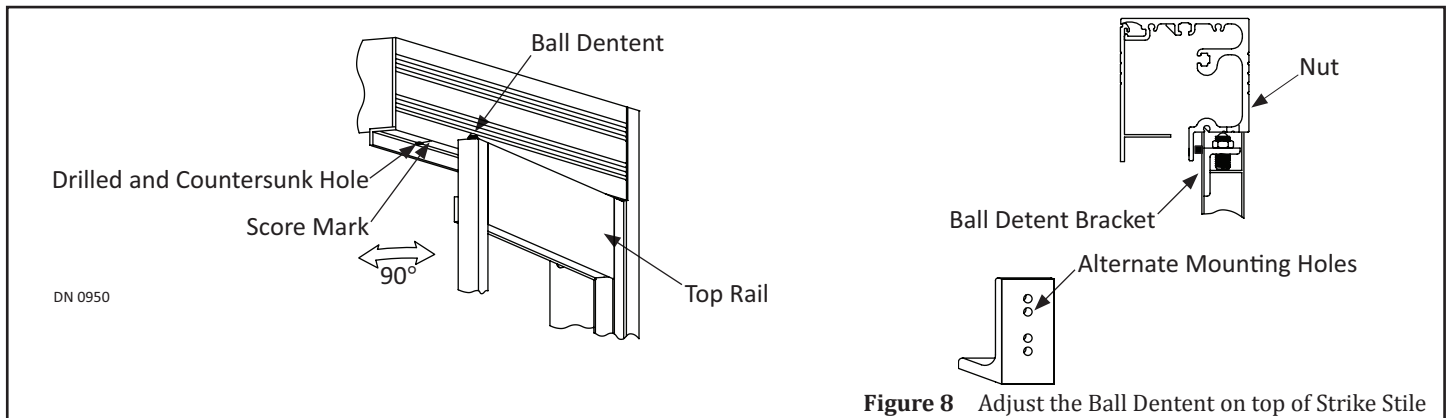

4. With a 15/16" Open End wrench, loosen the Nut to raise or lower the Ball Detent at Bottom of Strike Stile so it has light contact with the Floor Track.
5. Open and close the Swing Door several times to score the surface on the Floor Track.
6. Locate and mark where the Score intersects the center groove.
7. With a 1/4 inch diameter drill bit, drill a hole through the Floor Track (Just deep enough for the Ball Detent to fit within). Countersink the screw hole to be 1/4 inch x 82°.

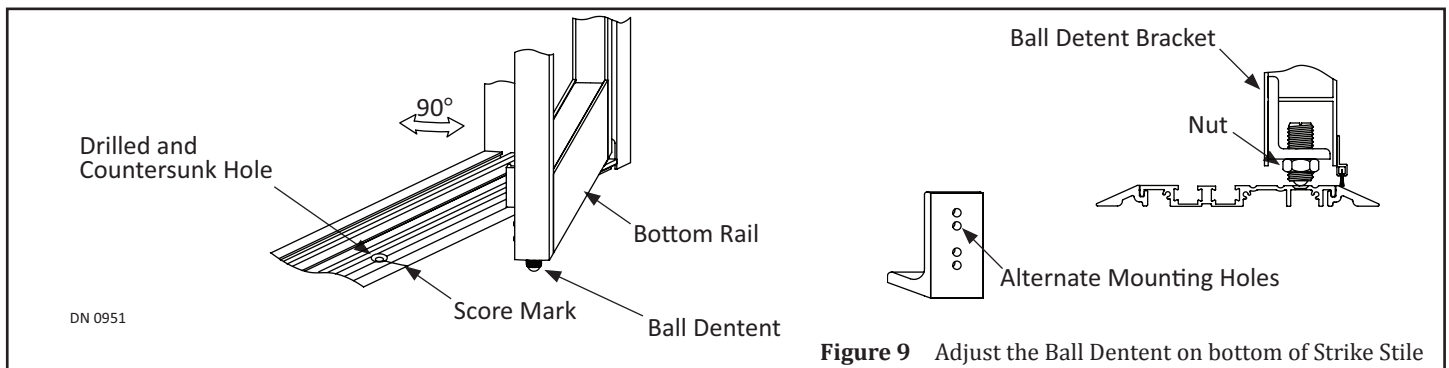

8. Close and then break open the Swing door to test fit both Ball Detents.
  - a. Increase hole size and countersink size until a satisfactory fit is obtained.
  - b. Do Not over-drill the hole. If hole is overdrilled the Floor Track will need to be replaced.
  - c. For additional travel remove the ball Detent Bracket to lower or raise the Ball Detent.

#### 5 Install the Slide Door

1. Cover the Sidelite Panel with cardboard on the non-breakout side.
2. Remove each Roller located at the front of Carrier. Refer to the instruction sticker to reinstall each Roller to the back of Carrier. Ensure each Roller is horizontally aligned to each other. Please see Figure 10.

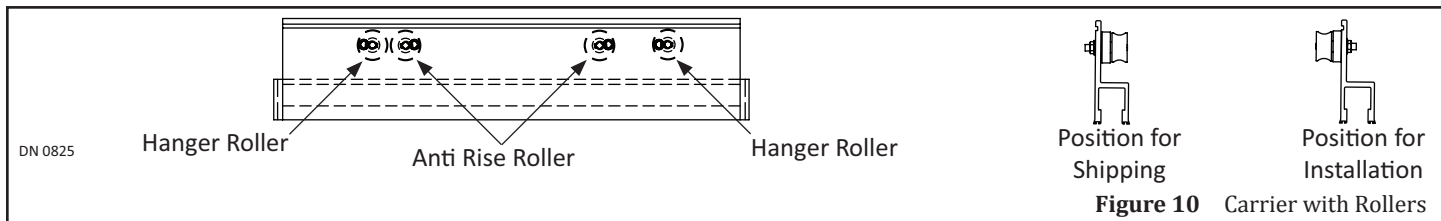

3. Slightly tilt the Slide door to make it easier for the (4) Rollers to 'catch' onto the track.
4. Pry up on the pre-installed Full Open Bottom Guide so the prongs can enter the Floor Track in the appropriate slots.

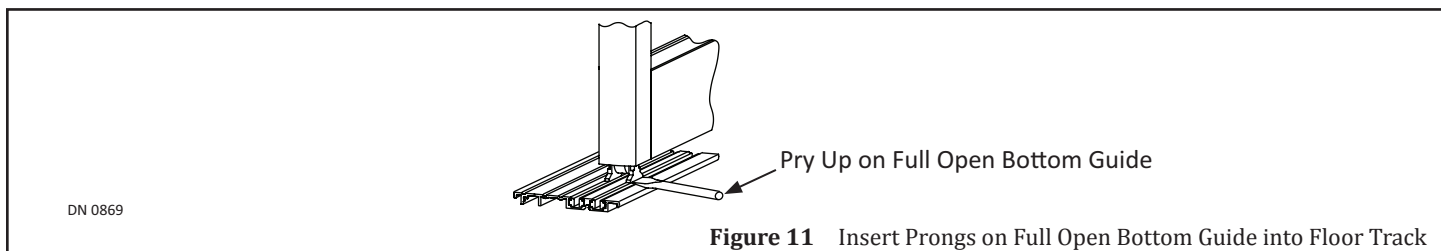

5. Adjust the Slide Door in Section "7 Adjustments".

## 6 Secure the Floor Track

1. Obtain #10 x 1-1/2 inch sheet metal screws and #6 Green Anchors provided by NABCO.
  - a. The number of provided screws and anchors depends upon length of Floor Track.
2. Go to a metal strip that is used to divide the Filler Inserts.
3. Go to each end of Floor Track. Mark (1) drill hole approximately 4" from each edge.
4. With a 1/4 inch masonry drill bit, drill through the Floor Track and into the floor no less than 1-1/2 inch deep.
5. Insert plastic anchors into the drilled holes.
6. Secure the Floor Track with #10 x 1-1/2 inch sheet metal screws.

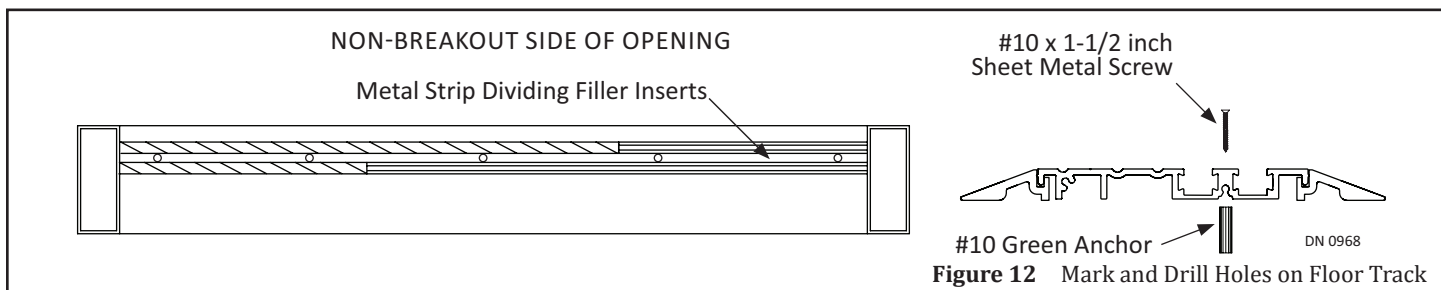

## 7 Adjustments

### 7.1 Adjust Height on Slide Door

**CAUTION**

**Do Not rotate the stud counter-clockwise. Doing so will unthread the Axle from the Hanger Roller assembly.**

1. Measure the gap between the door and the floor. The gap must be between 3/16" to 7/16" (3/8" nominal).
2. Loosen each Hanger Roller Nut. It is recommended to adjust the (2) Hanger Rollers located at each end of door first.
3. Turn each axle clockwise to raise or lower the Sliding door. Retighten each Hanger Roller nut. Do not overtighten.
4. Loosen each Anti-Rise Roller nut. Turn each axle clockwise until each Anti-Rise Roller almost makes contact with the top of Roller Track. Gap should be about the same thickness of a credit card. Retighten each Anti-Rise Roller nut. Do not overtighten.

### 7.2 Adjust Preload on Slide Door

**CAUTION**

**Glass must be installed first before adjusting Preload on Slide Door.**

**CAUTION**

**When a Preload Block is shifted, it will be necessary to gently tap on one end of the Interface Leg (located inside the Carrier) until it is properly recentered.**

1. Support the weight of sliding door. Breakout sliding door approximately 75 degrees. Check for door sag.
2. Go to the Preload Block located inside the Top Rail. Loosen (2) Locking Bolts.
3. Go to the back edge of Pivot Stile. Reduce door sag by tightening the 5/16 inch Adjustment Set Screw with a 5/32 inch Allen Wrench.
  - a. The door should lift without having to be manually lifted.
  - b. Do not allow the Adjusting Set Screw to protrude more than 5/32 inch past the end of stile.
  - c. If an optional 1/2 inch Adjustment Set Screw provided by NABCO is deemed necessary, it could mean the Preload is misaligned. Go to Section 7.3 before replacing the 5/32 inch Adjustment screw.

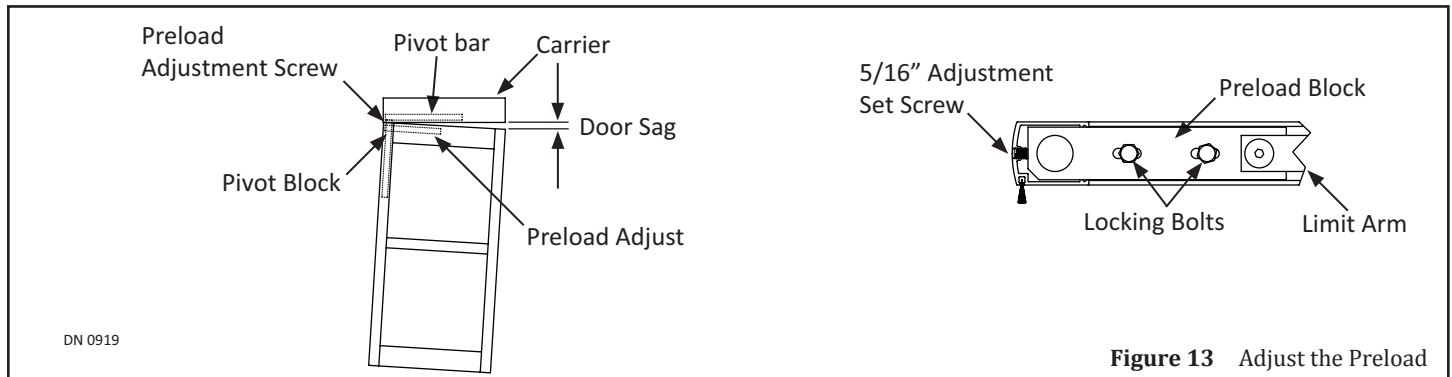

Figure 13 Adjust the Preload

### 7.3 Correct Preload Misalignment

1. Check to see if misalignment exists on the Strike end of the Door and Carrier.
2. Loosen the Allen head fasteners on the Pivot bar that is located inside the Carrier. Slide the Pivot bar until the door and Carrier are properly aligned.
3. Verify that the Panic Catch inside the Top Rail and the Carrier are still aligned. If not, loosen the 5/16 inch set screw to align the Carrier Panic Catch with the Top Rail Panic Catch.

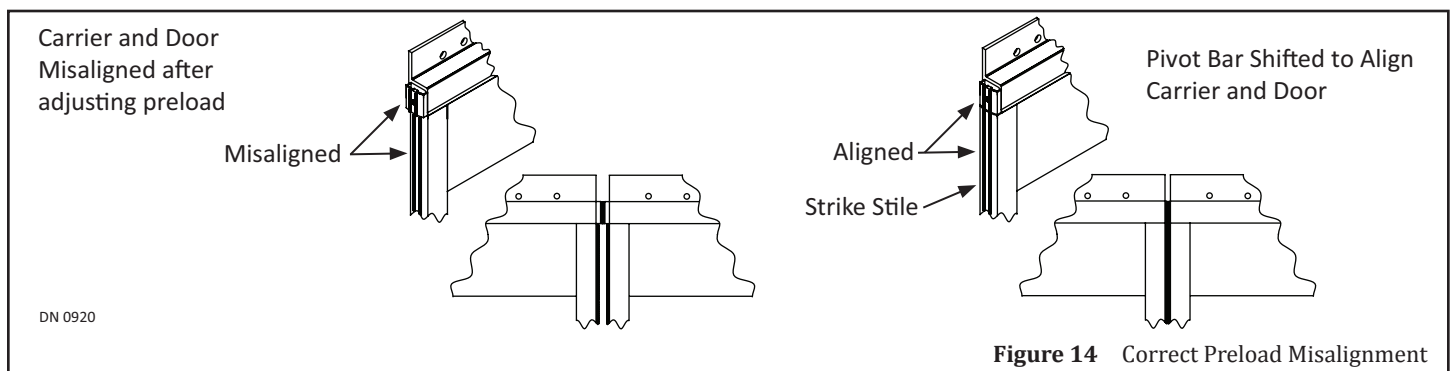

Figure 14 Correct Preload Misalignment

### 7.4 Adjust the Nose Caster

*Note: Nose Casters are pre-installed for Sliding Doors that are 54 inches Wide (or greater) and/or over 200 pounds.*

1. Loosen the #8-32 Set Screw. Position the Wheel so it is perpendicular to the Bottom Rail.
2. Retighten the #8-32 Set Screw.
3. Break open the Slide door. Ensure the Slide door does not scrape the floor. If it does lower the Nose Caster further.

## 8 Self Close Header

### 8.1 Wire Components within Header

1. Ensure all power is disconnected at the Junction box and Slide door unit. Inspect the location and grade of all Incoming 120 VAC power cables.
2. Wire the components according to illustration shown below.

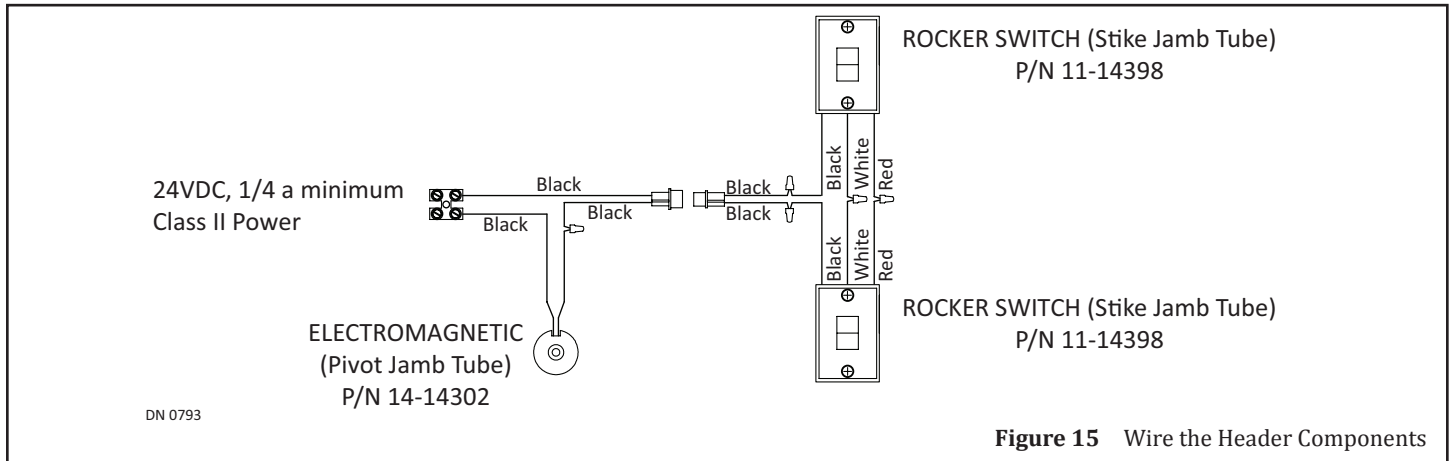

Figure 15 Wire the Header Components

### 8.2 Align the Rotary Damper to the Control Rack

1. Loosen (2) #10 Hex nuts that are used to secure the Rotary Damper to the Header. Slide open the door until the Rotary Damper is directly underneath the Control Rack. Slide the Rotary Damper up the slot until the teeth can fit inside the Control Rack teeth. Slide door back and forth to check for binding or chatter.

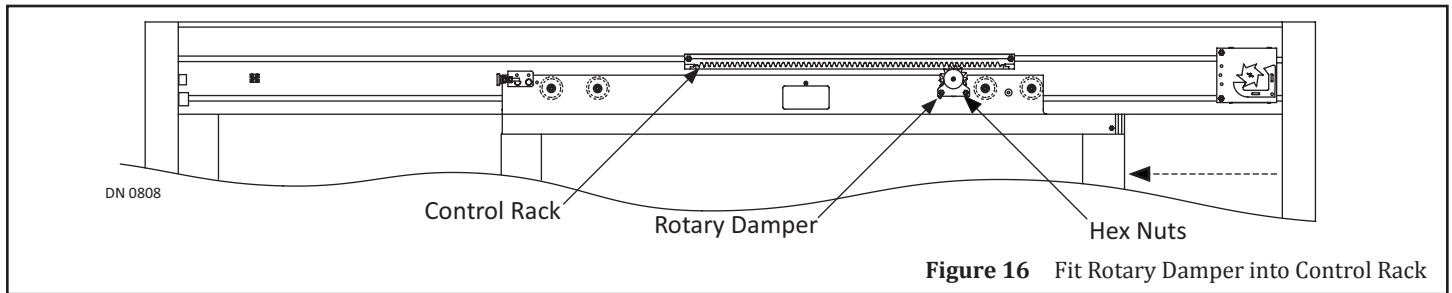

Figure 16 Fit Rotary Damper into Control Rack

### 8.3 Attach the Pull Spring to the Carrier

1. Close the Slide door. Go to the Shoulder Bolt located between (2) Hanger Rollers closest to the Strike Jamb. Remove the Shoulder Bolt with a 3/16 inch Allen Wrench.
2. Attach the Pull Spring to the Shoulder Bolt. Reinstall the Shoulder Bolt with the Pull Spring attached.

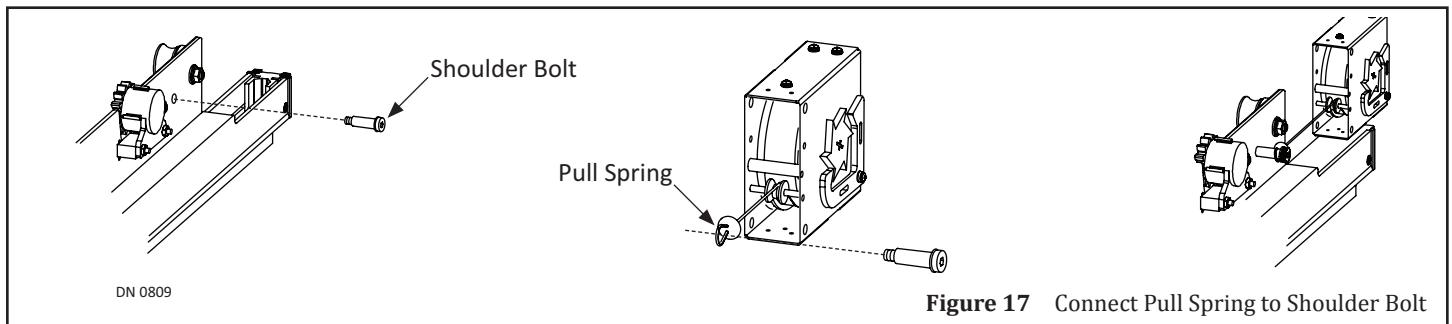
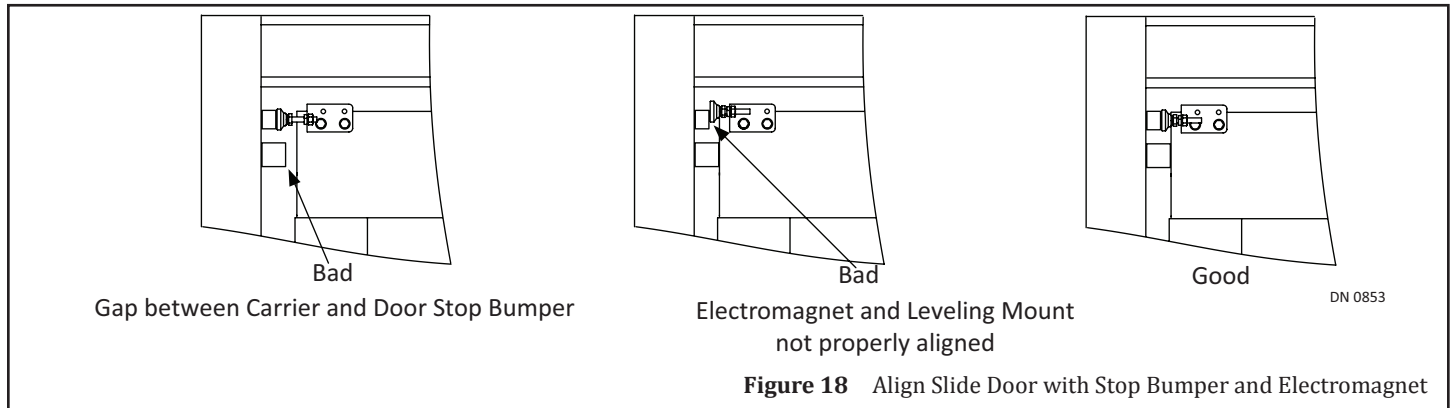

Figure 17 Connect Pull Spring to Shoulder Bolt

### 8.4 Align Slide Door with Electromagnet and Door Stop Bumper

1. Loosen (2) Hex nuts on the Magnetic Strike. Slide the Carrier until it is against the Slide door Bumper.
2. While holding the Carrier to the Slide door Bumper, adjust the Magnetic Strike to contact and align with the Magnet on the Jamb Tube. Tighten Hex Nuts. Please see Figure 18.



### 8.5 Adjust Closing Speed if Slide door does not Fully Close (Self Close Units)

1. Open the Slide door. Allow Slide door to fully close. It should close slowly. If Slide door does not close slowly, go to the Pull Spring. With a Flathead screwdriver turn the Tension plate counterclockwise to increase tension.

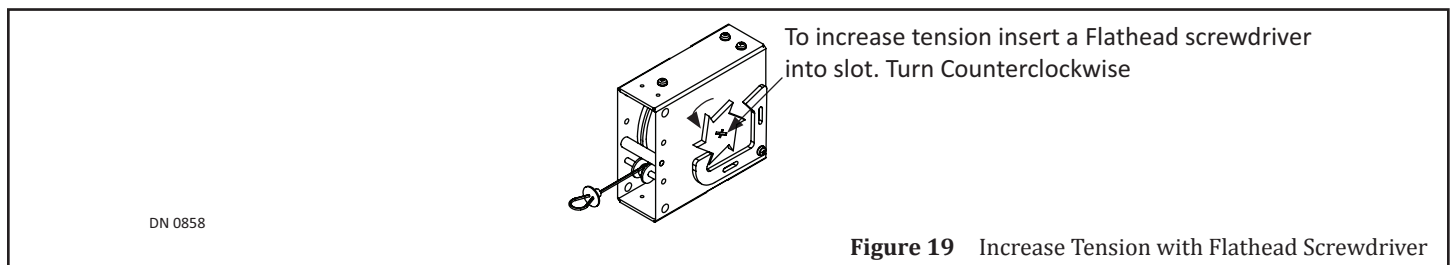

### 8.6 Adjust Closing Speed if Slide door closes Too Fast (Self Close Units)

1. Go to the Pull Spring.
2. With both index fingers carefully push the Tension Bracket forward so the Tension Plate clicks clockwise. This will decrease tension on the Pull Spring.
3. With both thumbs push the Tension Bracket back to starting position. Do not pinch fingers while setting the tension.
4. For more speed control, adjust the Rotary Damper (turn the dial clockwise to increase damping, counterclockwise to decrease damping).

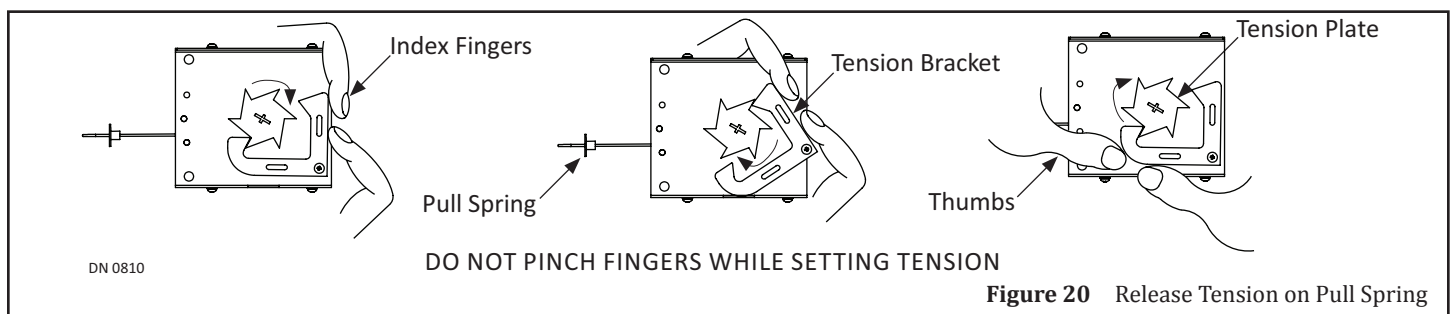

### 8.7 Fine Tune the Latching Speed

- ▶ To increase Latching speed:
  1. Move the Control Rack farther away from the Strike Jamb Tube.
  2. Adjust the Pull Spring and Rotary Damper after moving the control rack.
- ▶ To decrease Latching speed:
  1. Move the control rack closer to the Strike Jamb Tube. Slide door will move faster before hitting the Control Rack.
  2. Adjust the Pull Spring and Rotary Damper after moving the Control Rack.



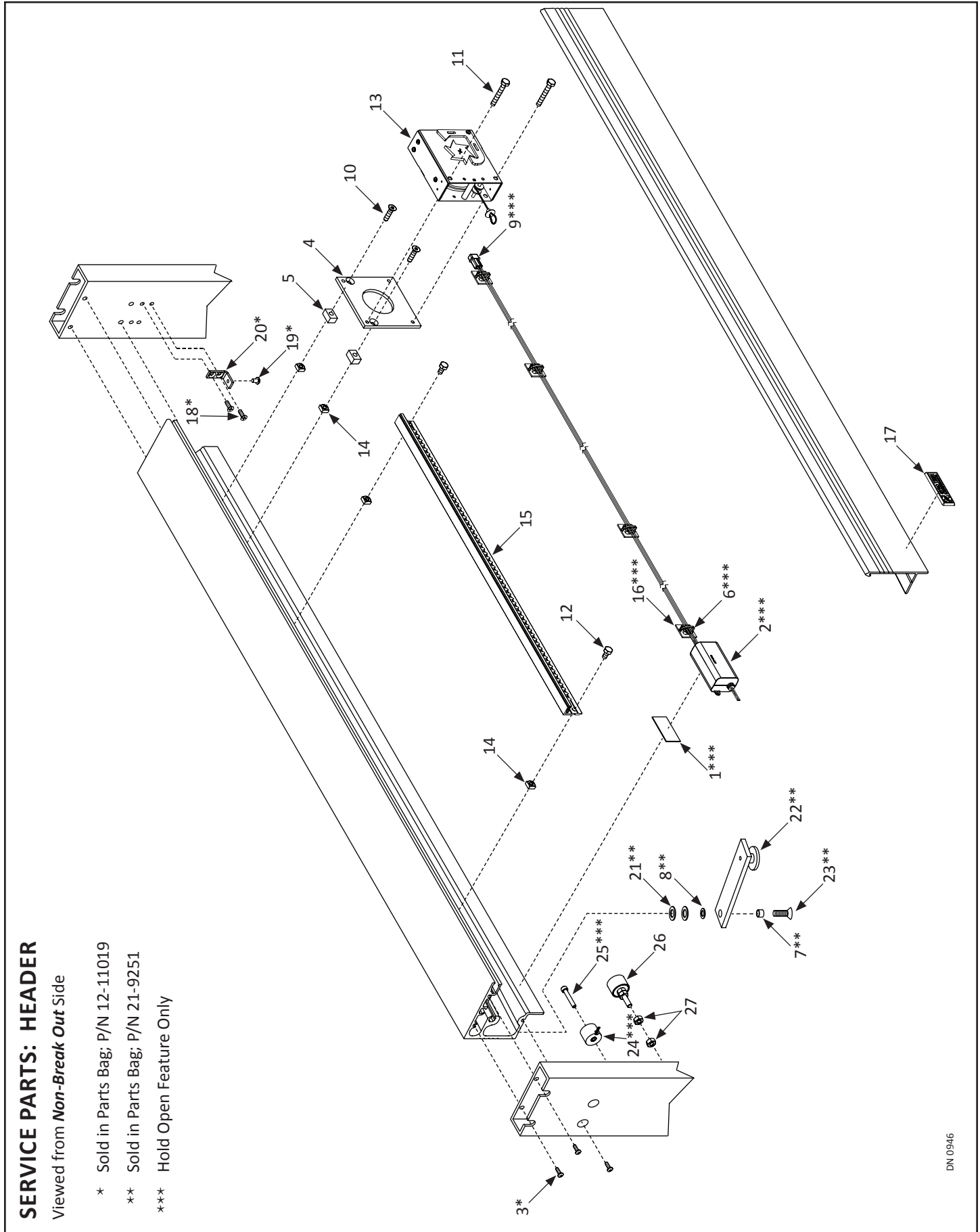

**SERVICE PARTS: HEADER**

Viewed from *Non-Break Out* Side

- \* Sold in Parts Bag; P/N 12-11019
- \*\* Sold in Parts Bag; P/N 21-9251
- \*\*\* Hold Open Feature Only

Header			
Item	Part	Finish/Sizes/Notes	Description
1	14-13769	Hold Open Feature Only	TAPE, DBL. SIDE, FOAM 1" X 2" .045THK
2	14-14299	Hold Open Feature Only	POWER SUPPLY, 24VDC
3	24-0015-61	Zinc	RHMS,1/4-20 X 3/4" PHIL, TYPE F, ZN
4	14-14326		PULL SPRING MOUNTING BRACKET
5	14-14327		PULL SPRING SPACER
6	14-1473-10	Hold Open Feature Only	CABLE TIE, 4"
7	14-8658		SPACER, LIMIT ARM
8	24-0017-04		WASHER, 1/4 ID X 9/16 OD X .049 THK, STL
9	11-14352	Hold Open Feature Only	SELF-CLOSER HOLD OPEN HEADER HARNESS
10	24-0011-21	Zinc	FHCS, 1/4-20 X 1", ZN
11	24-0014-12		HHCS,1/4-20 X 1 3/4"
12	24-0014-23		HHCS,1/4-20 X 1/2"
13	14-14316		MACHINED PULL SPRING
14	24-0021-27		SQUARE NUT, 1/4-20
15	24-14304		MACHINED CONTROL RACK
16	24-9442	Hold Open Feature Only	TIE MOUNT ADHESIVE BACKED
17	14-9199		NAMEPLATE, ADHESIVE BACKED
18	24-0011-70	Zinc	FHMS, 1/4-20 X 7/16", PHIL, UND, ZN
19	24-0015-22	Zinc	RHMS,#8-32 X 1/4", PHIL, ZN
20	14-10727		CLIP, COVER
21	24-0017-14		WASHER, 5/16 ID X 3/4 OD X .062 THK
22	21-8160		LIMIT ARM ASSY, SWING PANEL
23	22-3590-06		SCREW - PHILLIPS FL HD W/VIBR 1/4-20 X 1
24	14-14302		ELECTROMAGNET
25	24-0010-34		SCREW - SOCKET HEAD CAP #8-32 X 1
26	12-8233		DOOR STOP ASSY JAMB MOUNTD-SPECIAL
27	24-0667-01		SPACER, MOUNTING - END CAP-UL PART

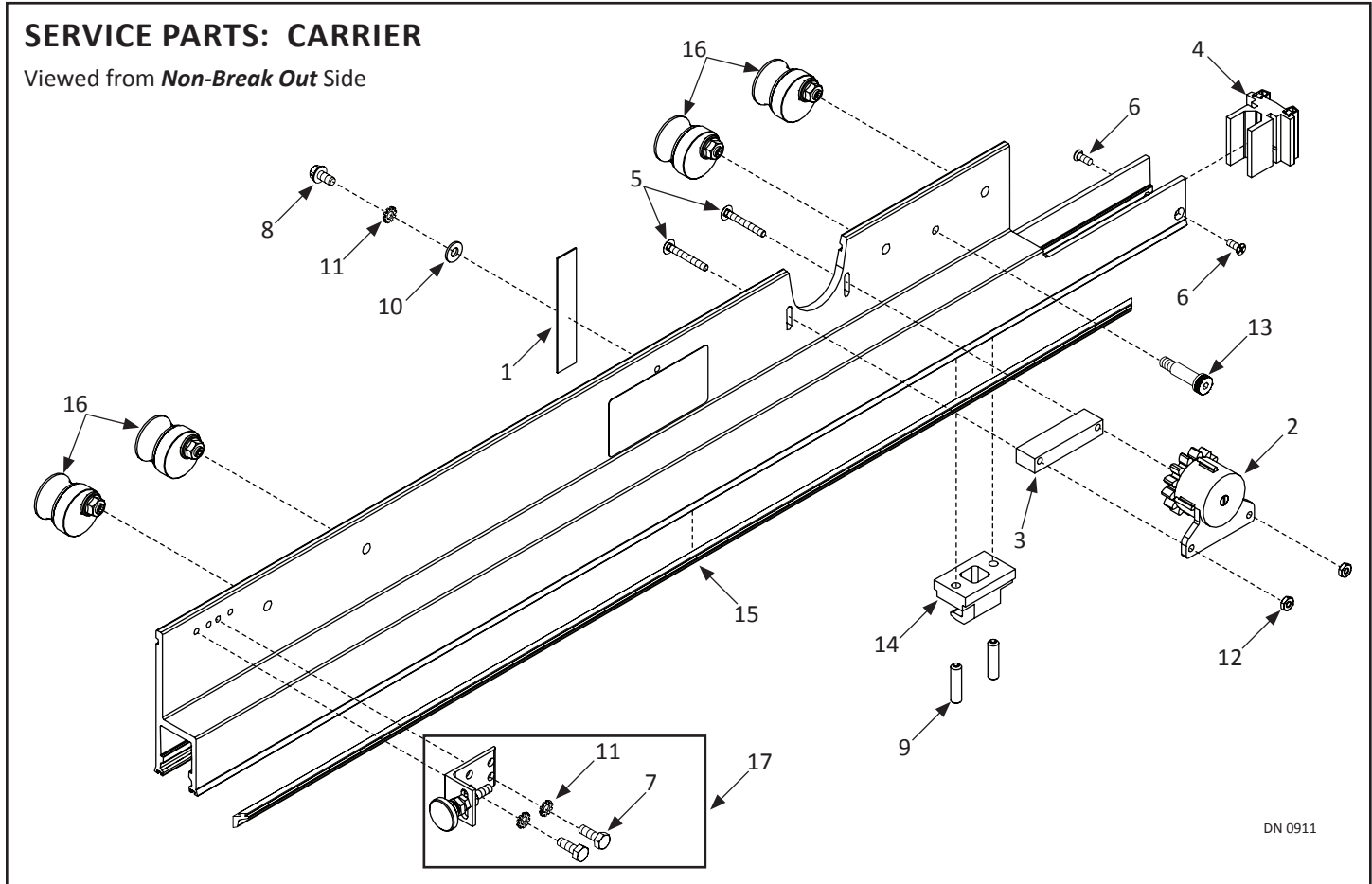

DN 0911

<b>Carrier</b>				
<b>Item</b>	<b>Part</b>	<b>Finish/Sizes/Notes</b>	<b>Description</b>	
1	14-10907-01		STATIC ARRESTOR STRIP 4"	
2	14-13959-10		ROTARY DAMPER, RIGHT HAND, SC-C08	
	14-13959-20		ROTARY DAMPER, LEFT HAND, SC-C08	
3	14-14313		ROTARY DAMPER SPACER	
4	14-14321		END CAP, MACHINED SELF-CLOSER CARRIER	
5	14-14329	Zinc	CARRIAGE SCREW,10-24 X 1.5", ZN	
6	24-0011-105	Zinc	FHMS, 10-32 X 1/2", PHIL, UND, ZN	
7	24-0014-02	Zinc	HHCS, 1/4-20 X 3/4", ZN	
8	24-0014-39	Green	HWHMS, 1/4-20 X 3/8", SLOT, GREEN	
9	24-0016-30		SHSS, 5/16-18 X 1.25", CUP	
10	24-0017-46		WASHER, FLAT 1/4X5/8X.051/.080	
11	24-0019-05		1/4" EXTERNAL STAR WASHER	
12	24-0021-04		HEX NUT #10-24	
13	24-1247-07		BOLT, SHOULDER 3/8" DIA X 1"	
14	24-9483		PANIC CATCH, UPPER PART	
15	24-9094		DOOR CARRIER INTERFACE LEG	
16	12-10027		30mm HANGER ROLLER & HUB SUBASSY	
17	11-14325-10		ASSY, RH HOLD OPEN BRKT	

### SERVICE PARTS: FULL OPEN SIDELITE

Viewed from *Non-Break Out* Side

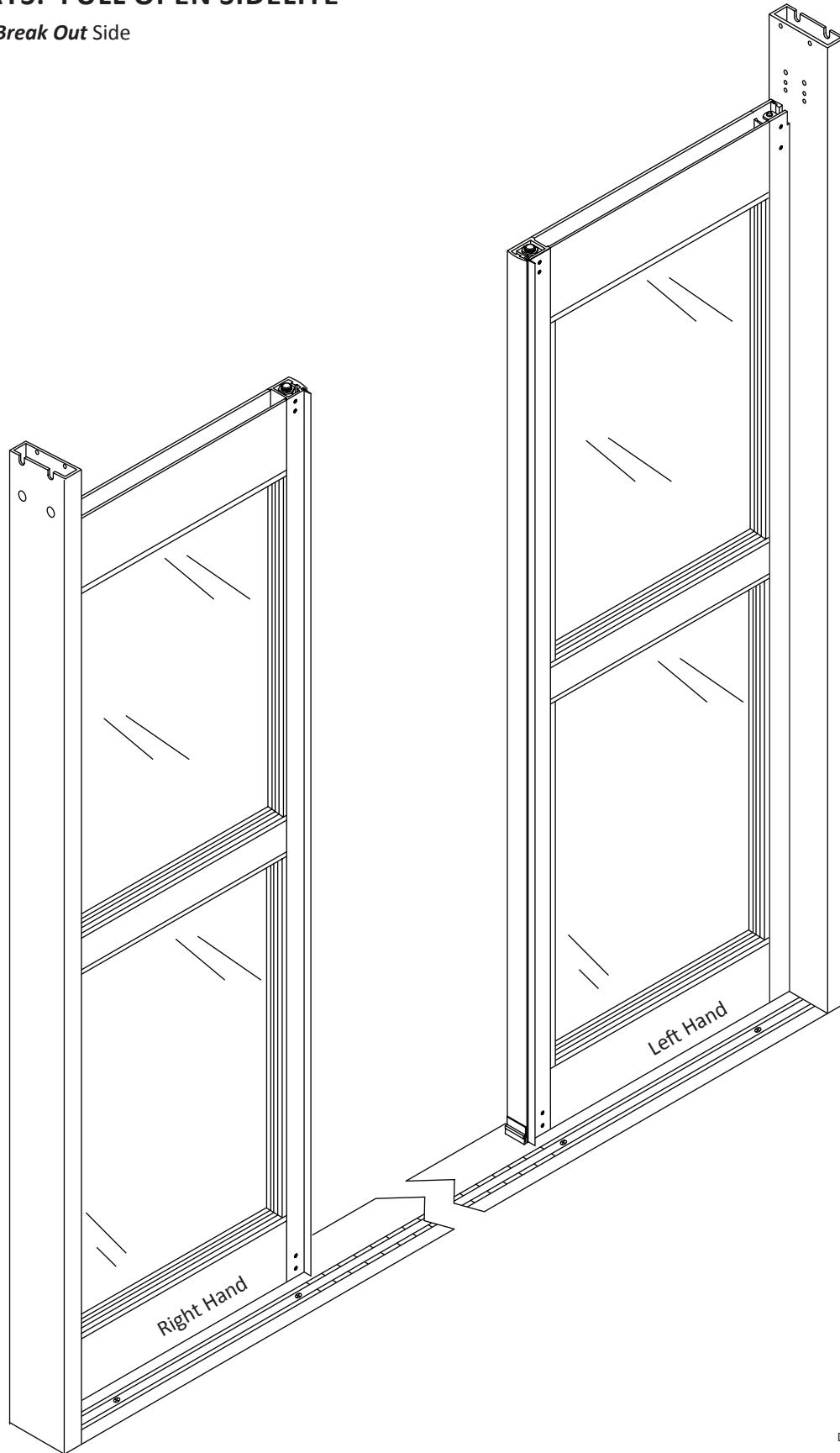

DN 0943

# SERVICE PARTS: RIGHT HAND FULL OPEN SIDELITE

Viewed from *Non-Break Out* Side

\* Sold in Parts Bag; P/N 21-9251

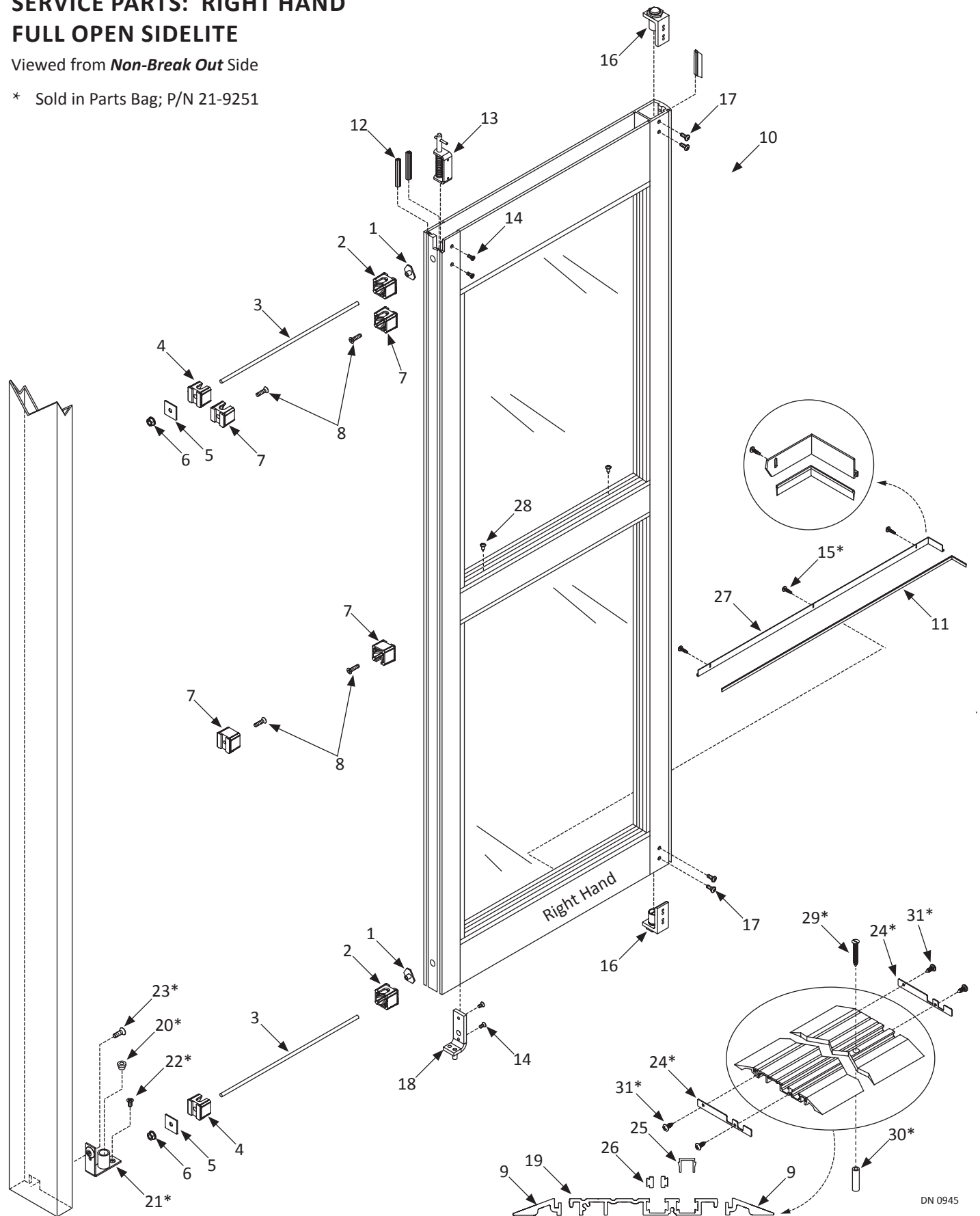

DN 0945

# SERVICE PARTS: LEFT HAND FULL OPEN SIDELITE

Viewed from **Non-Break Out** Side

\* Sold in Parts Bag; P/N 21-9251

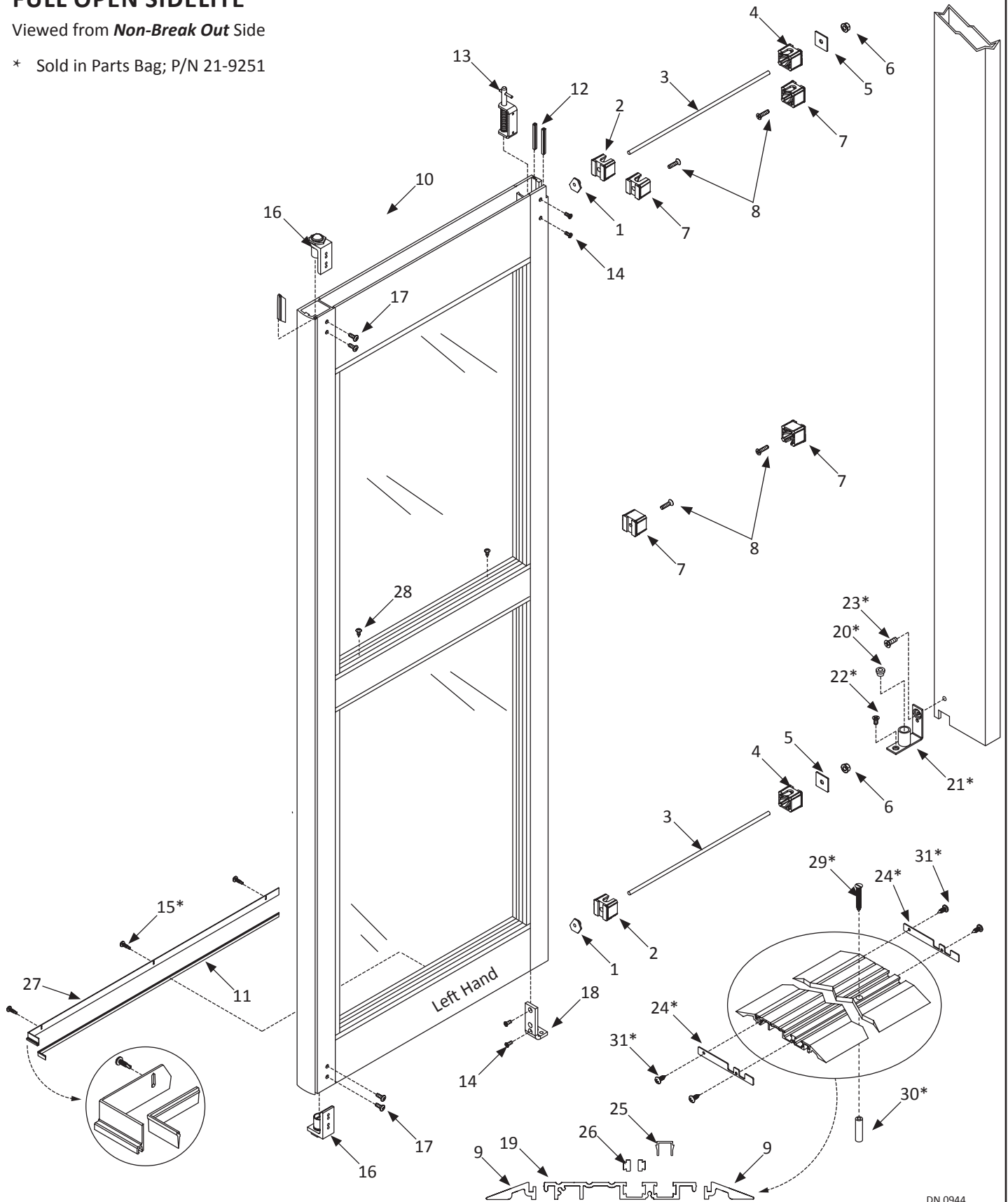

DN 0944

Sidelite			
Item	Part	Finish/Sizes/Notes	Description
1	14-9279		OFFSET TEE NUT, 3/8"-16
2	24-9503		CLIP, MUNTIN BAR - RAIL .500 HOLE
3	14-3624	Zinc	THREADED ROD, 3/8"-16 - ZINC PLATED
4	24-9504		CLIP, MUNTIN BAR - RAIL .386 HOLE
5	14-9225		BACKING PLATE, TIE ROD - DOOR ASSEMBLY
6	24-0021-21	Zinc	NUT, WHIZLOCK, 3/8-16, ZN
7	24-9502		CLIP, MUNTIN BAR - RAIL .261 HOLE
8	24-4941-02	Zinc	FHMS, 1/4-20 X 1", PHIL, TRILOBE, ZN
9	14-9017-01		EXTRUSION, ALUM - RAMP, FLOORTRACK
10	14-5592-01	Smoke Seal Only/Gray	WEATHER STRIP - 9/16 IN VINYL FIN, GRAY
	14-5592-02	Smoke Seal Only/Black	WEATHER STRIP - 9/16 IN VINYL FIN, BLACK
11	14-3933-01	Smoke Seal Only/1 inch/Gray	WEATHERING GRAY VINYL 1 IN FIN
	14-3933-02	Smoke Seal Only/1 inch/Black	WEATHERING BLACK VINYL 1 IN FIN
12	14-8632	Black	WEATHERING TRI POLY BLACK BULB
13	21-9507		ASM, TOP PIVOT, 1175 SWING PANEL
14	24-0011-105		FHMS, 10-32 X 1/2", PHIL, UND, ZN
15	24-0013-03	Smoke Seal Only/Zinc	PHSMS, 6 X 1/2", PHIL, TEKS, ZN
	24-0013-04	Smoke Seal Only/Black Zinc	PHSMS, 6 X 1/2", PHIL, TEKS, BLK ZN
16	12-9082		BALL DETENT PANIC, SWING PANEL
17	24-0012-14		PHMS, #10-32 X .50 LG, PHL, ZINC
18	11-9509-01	LH	BOTTOM PIVOT SWING PANEL ASSY - LH
	11-9509-02	RH	BOTTOM PIVOT SWING PANEL ASSY - RH
19	14-9016-01		EXTRUSION, ALUM - THRESHOLD, FLOOR TRACK
20	24-2458		BOTTOM PIVOT BUSHING, SWING PANEL
21	22-4750		FLOOR PIVOT SUB-ASSY - GT1100 & 1175
22	24-4941-01		FHMS, 1/4-20 X 1/2", TYP F, UND, PHL, ZN
23	24-0011-13		FHMS, 1/4-20 X 3/4", PHIL, ZN
24	24-9857-10		END CAP, THRESHOLD - NORMAL FULL OPEN
25	14-9168		EXTRUSION, RPVC - FILLER, TRACK
26	14-9019		BUMPER, THRESHOLD
27	14-10659-01	Smoke Seal Only/LH/Clear	WEATHERING HOLDER
	14-10659-02	Smoke Seal Only/LH/Dark Bronze	WEATHERING HOLDER
	14-10660-01	Smoke Seal Only/RH/Clear	WEATHERING HOLDER
	14-10660-02	Smoke Seal Only/RH/Dark Bronze	WEATHERING HOLDER
28	24-0031-23		FHSMS, 10 X 3/4", TYPE A, PHIL, ZN
29	24-0031-17		FHSMS, 8 X 1 1/2", TYPE A, PHIL
30	14-6394		ANCHOR, STRT PLSTC 10-12" X 1"
31	24-0094-12		PHSMS, 6 X 3/8", TYPE AB, PHIL

### SERVICE PARTS: SLIDE DOOR

Viewed from *Non-Break Out* Side

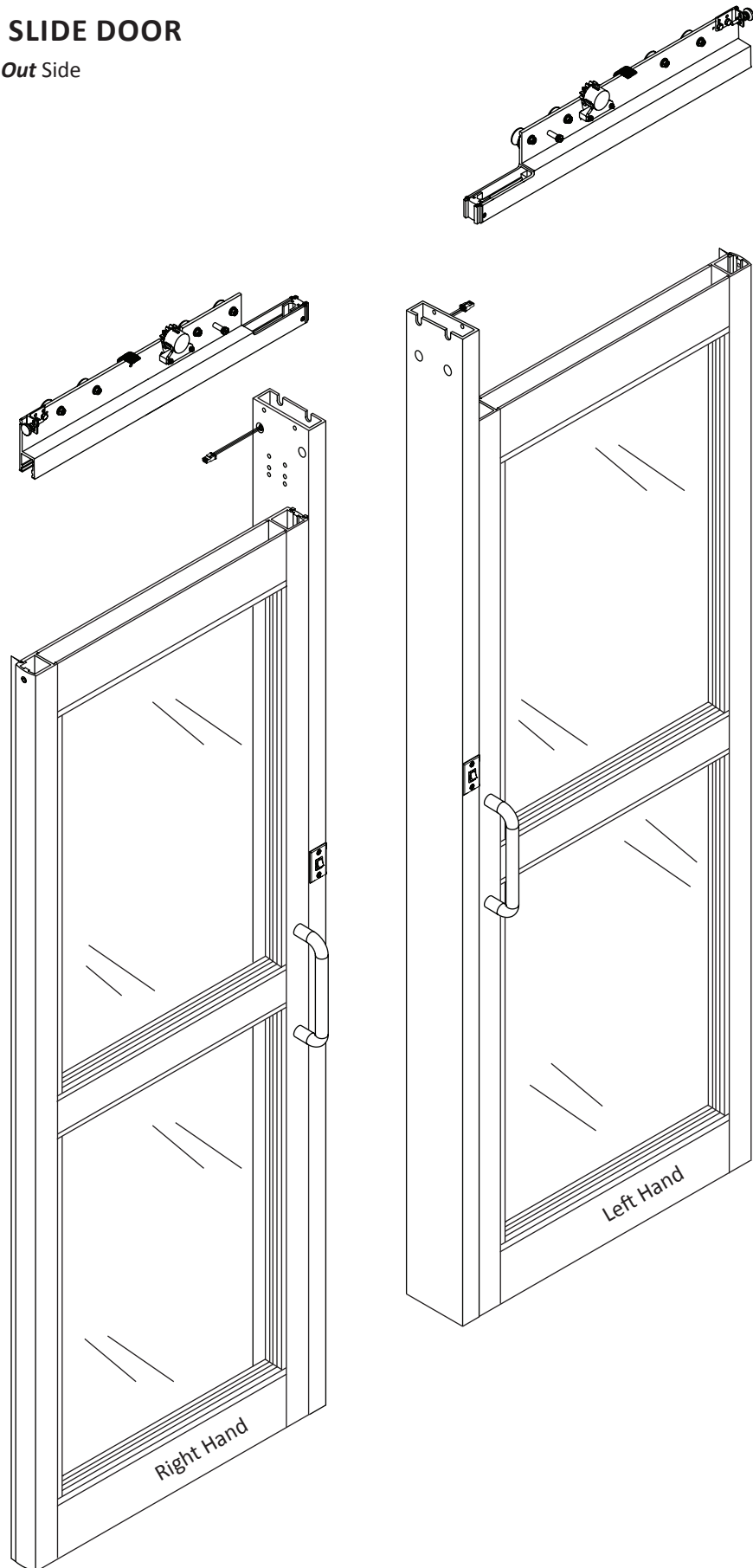

DN 0913



# SERVICE PARTS: RIGHT HAND SLIDE DOOR

Viewed from *Non-Break Out* Side

\* Sold in Parts Bag; P/N 21-9251

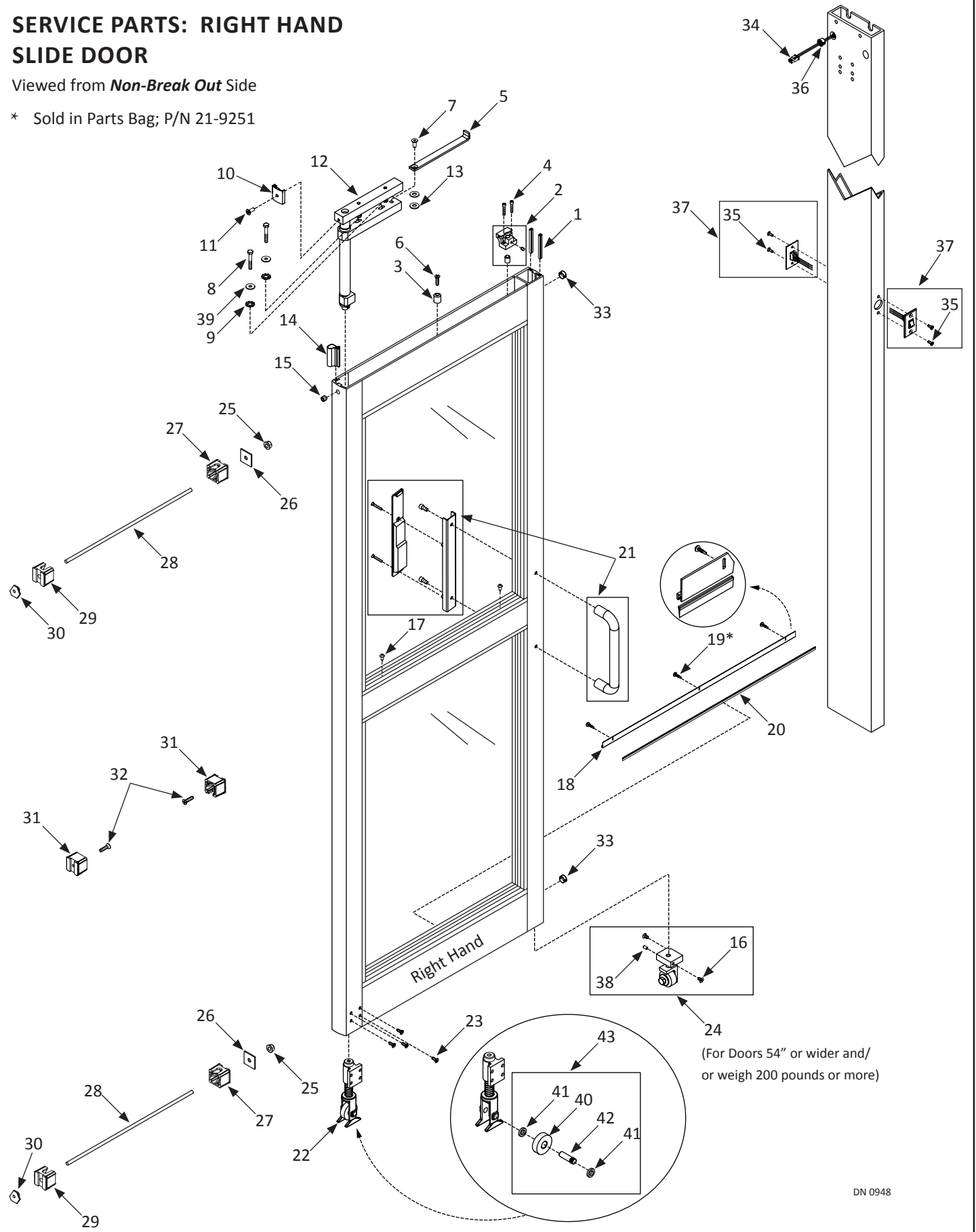

DN 0948

# SERVICE PARTS: LEFT HAND SLIDE DOOR

Viewed from **Non-Break Out** Side

\* Sold in Parts Bag; P/N 21-9251

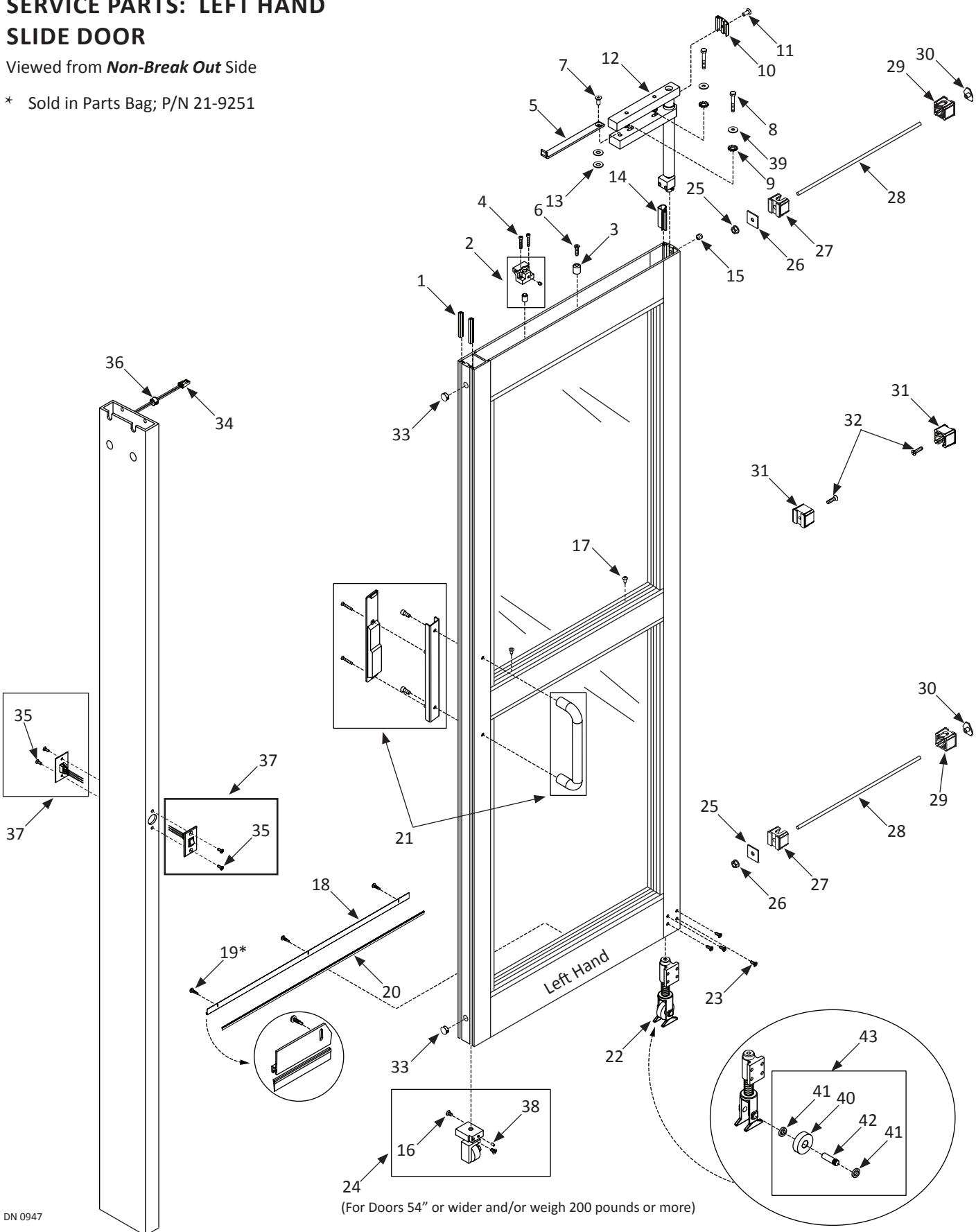

(For Doors 54" or wider and/or weigh 200 pounds or more)

Slide Door			
Item	Part	Finish/Sizes/Notes	Description
1	14-8632		WEATHERING TRI POLY BLACK BULB
2	21-3468-99		PANIC CATCH RELEASE ASSY, MODEL 1100
3	14-8447		LIMIT ARM SUPPORT
4	24-0010-16		SHCS, 1/4-20 X 1 1/4"
5	21-8396		LIMIT ARM, STD STILES
6	24-4941-02	Zinc	FHMS, 1/4-20 X 1", PHIL, TRILOBE, ZN
7	24-0011-77	Zinc	FHCS, 7/16-14 X 1", ZN
8	24-0014-12		HHCS,1/4-20 X 1 3/4"
9	24-0019-05		1/4" EXTERNAL STAR WASHER
10	14-10561-01	Clear	END CAP, PIVOT - TRAIL DOOR MILLED 204
	14-10561-02	Dark Bronze	END CAP, PIVOT - TRAIL DOOR 313
11	24-0011-130	Black Zinc	FHMS 10-32X1/2" PHIL TYP 23, UND, BLK ZN
	24-0011-131	Zinc	FHMS, 10-32X1/2", PHIL, TYP 23, UND, ZN
12	24-12002-10		CARRIER PVT ASSY NARROW STILE-UL PART
	24-12002-20		CARRIER PVT ASSY MED STILE-UL PART
	24-12002-30		CARRIER.PVT ASY - NRW STL-PNL <22.75-UL
	24-12002-40		CARRIER.PVT ASY - MD STL- PNL < 22.75"UL
13	24-0017-02		WASHER, 7/16 ID X 1 OD X .083 THK
14	14-5592-01	Smoke Seal Only/Gray	WEATHER STRIP - 9/16 IN VINYL FIN, GRAY
	14-5592-02	Smoke Seal Only/Black	WEATHER STRIP - 9/16 IN VINYL FIN, BLACK
15	24-0016-51	Black Oxide	SHSS, 5/16-24 X 5/16" CUP PT, BLK OX
16	24-0011-70	Zinc	FHMS, 1/4-20 X 7/16", PHIL, UND, ZN
	24-0011-73	Black Oxide	FHMS,1/4-20 X 7/16", PHIL, UND, BLK OX
17	24-0094-01		PHSMS, 10 X 1/2", PHIL, TYPE A
18	24-9125-01	Smoke Seal Only/Clear	WEATHERING EXT, 204
	24-9125-02	Smoke Seal Only/Dark Bronze	WEATHERING EXT, 313
19	24-0013-03	Smoke Seal Only/Zinc	PHSMS, 6 X 1/2", PHIL, TEKS, ZN
	24-0013-04	Smoke Seal Only/Black Zinc	PHSMS, 6 X 1/2", PHIL, TEKS, BLK ZN
20	14-3933-01	Smoke Seal Only/1 inch/Gray	WEATHERING GRAY VINYL 1 IN FIN
	14-3933-02	Smoke Seal Only/1 inch/Black	WEATHERING BLACK VINYL 1 IN FIN
21	12-12958-01	Clear	KIT, ICU D/RECESSED HANDLE
	12-12958-02	Dark Bronze	KIT, ICU D/RECESSED HANDLE
22	21-9053-01		BTM GUIDE ASSY - CAST NRW STILE-UL PART
23	24-0011-53		FHMS,10-32 X 1/2 ,PHIL,UL PART
24	14-5543-11	Clear	NOSE CASTER ASSY NARROW STILE
	14-5543-12	Dark Bronze	NOSE CASTER ASSY
	14-5543-21	Clear	NOSE CASTER ASSY MED. STILE
	14-5543-22	Dark Bronze	NOSE CASTER ASSY
25	24-0021-21	Zinc	NUT, WHIZLOCK, 3/8-16, ZN
26	14-9225		BACKING PLATE, TIE ROD - DOOR ASSEMBLY

Slide Door			
Item	Part	Finish/Sizes/Notes	Description
27	24-9504		CLIP, MUNTIN BAR - RAIL .386 HOLE
28	14-3624	Zinc	THREADED ROD, 3/8"-16 - ZINC PLATED
29	24-9503		CLIP, MUNTIN BAR - RAIL .500 HOLE
30	14-9279		OFFSET TEE NUT, 3/8"-16
31	24-9502		CLIP, MUNTIN BAR - RAIL .261 HOLE
32	24-4941-02	Zinc	FHMS, 1/4-20 X 1", PHIL, TRILOBE, ZN
33	14-9511-04		PLUG, HOLE, .813 DIAMETER, BLK
34	11-14349		HOLD OPEN STRIKE JAMB HARNESS
35	11-14398		2-WAY SWITCH ASSEMBLY
36	14-12490		BUSHING, ELECTRICAL, .750 HOLE
37	24-0011-104	Black Oxide	FHMS,10-32 X 1/2", UND, BLK OX
38	24-0016-05		SHSS, 8-32 X 5/16, CUP PT
39	24-0017-04		WASHER, 1/4 ID X 9/16 OD X .049 THK, STL
40	14-9045-01		BTM ROLLER DOOR URETHANE-ULPART
	14-9045-02		BTM RLR DOOR URETH MED STILE-UL PART
41	24-0667-01		SPACER, MOUNTING - END CAP-UL PART
42	14-7061		SHAFT, ROLLER-UL PART
43	14-11320-10		KIT, ASSY, REPAIR, GT1175, NARROW STILES
	14-11320-20		KIT, ASSY, REPAIR, GT1175, MEDIUM STILES